

## LT4 Interlock Contactor



LT 4-Dxx series contactors are specially designed electromagnetic devices for commutation of three phase induction motor with reversing controlling scheme. They represent two alternating current contactors LT 4-Dxx series factory mechanically joined together. The mechanical joining also provides locking of the contactors against simultaneous switching on. The contactor is used for reverse control of induction motors with shortly joined motor. The contactors from the series are offered for consumers up to 95A.

### Documents corresponding to the product:

Standard  
EN60947-1, EN 60947-4-1

The products are in accordance with the directives of EC "Low voltage directives (LVD) no. 73/23 EEC" and "Electromagnetic Compatibility Directives (EMC) no. 89/336 EEC".

### Functions

- switching on of electrical motors in one direction of rotation and reversing of the rotation direction at out sited command
- making of control systems
- remarkable with high reliability of current characteristics
- reliable switching on or separation of power contacts
- secured part of the contactors against consumer contact
- secured cover of the movable part of the contactor
- impossibility for simultaneous switching on of the two contactors from the group due to mechanical locking

### Technical data

- \* Operation class: AC3
- \* Rated operating voltage of the controlling coil: 230V AC; 50/60Hz
- \* Rated operating voltage of the power circuit: up to 690V AC
- \* Insulation voltage: 690V
- \* Surge voltage wear resistance: >8000v
- \* Limits of the controlling coil voltage: from 0.8 to 1.15 U<sub>c</sub>
- \* Number of plugs: 3 No power contacts +1NO operative (for contactors over 40A there is also additional 1NC contact)
- \* Joining terminal: screw terminal
- \* Connecting:
  - flexible conductors with or without cable terminal
  - rigid conductors
- Note: The contactors are offered without fabric cabling
- \* Electrical wear resistance (number of cycles): 1 000 000
- \* Mechanical wear resistance (number of cycles): 10 000 000
- \* Number of cycles (switching on) per hour: up to 600
- \* Pole leaking power: up to 13w
- \* Mounting:
  - on Din-rail or
  - with bolts to the surface
  - mounting position: vertical gradient maximum  $\pm 5^\circ$
- \* Plastic: wear resistance of UV rays and non-flammable (self-extinguishing material)
- \* Ambient temperature:  $-10^\circ\text{C} \sim 60^\circ\text{C}$
- \* Altitude: up to 2000m

### Dimensions

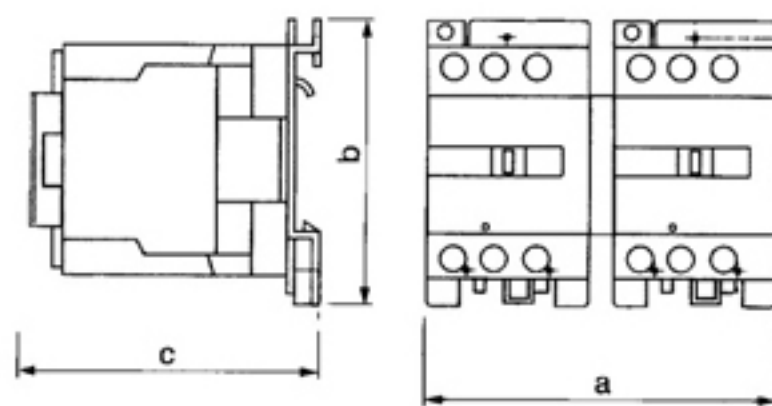

Type(number)	A(mm)	B(mm)	C(mm)
LT4-D1810	90	77	83
LT4-D2510	90	85	98
LT4-D3210	90	91	105
LT4-D4011	165	91	142
LT4-D6511	182	127	142
LT4-D9511	182	127	158

Type(number)	A(mm)	B(mm)	C(mm)
LT4-D1810	90	77	83
LT4-D2510	90	85	98
LT4-D3210	90	91	105
LT4-D4011	165	91	142
LT4-D6511	182	127	142
LT4-D9511	182	127	158