



**Features:**

- Approvals: SAA
- Certified to AS/NZS 3112 and AS/NZS 3133
- Rated Voltage: 250V AC
- Rated Frequency: 50/60Hz
- IP Protection: IP53

Part No.	Rating (Amps)	Specification	Qty/Ctn(pcs)
ABWPO110	10	1 gang switch	40
ABWPO210	10	2 gang switch	40

**Dimensions(mm)**

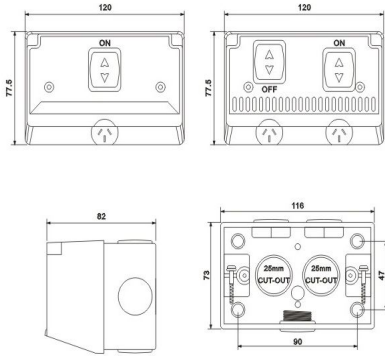

**Features:**

- Approvals: SAA
- Certified to AS/NZS 3112 and AS/NZS 3133
- Rated Voltage: 250V AC
- Rated Frequency: 50/60Hz
- IP Protection: IP53

Part No.	Rating (Amps)	Specification	Qty/Ctn(pcs)
ABWPS110H	10	1 gang switch	60
ABWPS115H	15	half size	60
ABWPS110	10	1 gang switch	40
ABWPS115	15	1 gang switch	40
ABWPS210	10	2 gang switch	40
ABWPS215	15	2 gang switch	40

**Dimensions(mm)**

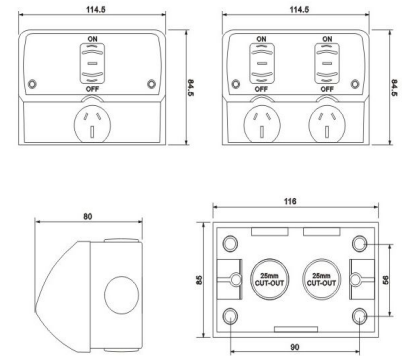

**Features:**

- Complied with AS/NZS 3133
- Rated Voltage: 250V AC
- Rated Frequency: 50Hz
- IP Protection: IP56

Part No.	Rating(Amps)	Specification	Qty/Ctn(pcs)
ABWS116	16	1 gang switch	40
ABWS216	16	2 gang switch	40

**Dimensions(mm)**



**Features:**

- Approvals: SAA, CB, CE
- Certified to AS/NZS 3947.3, IEC/EN60947-3
- Fix Neutral and Earth bars included
- Dual 25mm screwed conduit entries on top and bottom
- Utilization Category: AC22A/AC23A
- IP66 Rating on all models
- Number of Pole: 1/2/3/4 poles
- Rated Voltage: 250V~(1P)/500~(2P,3P,4P)
- Rated Frequency: 50/60Hz
- IP Protection: IP66

Part No.	Rating (Amps)	Voltage	M-Rating	Qty/Ctn(pcs)
AB(M)S120	20	250	M140	20
AB(M)S135	35		M180	
AB(M)S163	63	500	M200	20
AB(M)S220	20		M140	
AB(M)S235	35	500	M180	20
AB(M)S263	63		M200	
AB(M)S320	20	500	M100	20
AB(M)S335	35		M140	
AB(M)S363	63	500	M200	20
AB(M)S420	20		M100	
AB(M)S435	35	500	M140	20
AB(M)S463	63		M200	

**Dimensions(mm)**

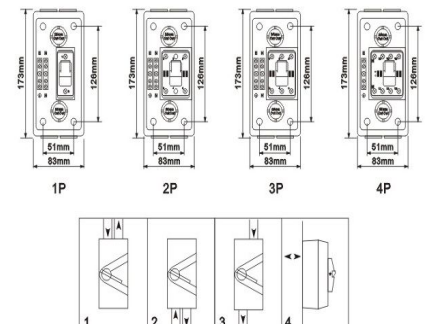

**Mini Weatherproof Switches**

**Features:**

- Compact size of 86x86x81mm
- Large rotary handle for easy operation even with gloved hands
- Padlock facility with 8mm pole in OFF position
- Ample conduit entries in the base, 2x25mm plain, 2x20mm and 1x20mm on each side of box as well as 1x25mm rear entry for back wiring
- IP Protection: IP66

Part No.	Rating(Amps)	Specification	Qty/Ctn(pcs)
ABWIS115	15	1 pole, 1 way	50
ABWIS120	20		
ABWIS215	15		
ABWIS220	20	2 pole, 2 way	

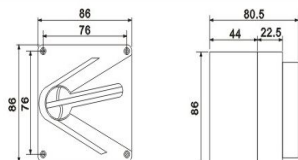



**Features:**

- Certified to: IEC60947-3, AS/NZS 3947
- Rated Voltage: 250/500V AC
- Rated Frequency: 50/60Hz
- Utilization Category: AC22A
- IP Protection: IP66
- TUV approval

Cat. No.	Rating (Amp)	Voltage (V)	Rated operational current			No. of Phase
			AC21A	AC22A	AC23A	
AB66SW110	10A	250	10	8	8	1
AB66SW115	15A	250	10	10	10	1
AB66SW120	20A	250	20	20	20	1
AB66SW215	15A	500	10	10	10	2
AB66SW220	20A	500	20	20	20	2
AB66SW232	32A	500	32	32	20	2
AB66SW240	40A	500	40	40	25	2
AB66SW250	50A	500	50	50	25	2
AB66SW263	63A	500	63	63	25	2
AB66SW315	15A	500	10	10	10	3
AB66SW320	20A	500	20	20	20	3
AB66SW332	32A	500	32	32	20	3
AB66SW340	40A	500	40	40	25	3
AB66SW350	50A	500	50	50	25	3
AB66SW363	63A	500	63	63	25	3

**Dimensions(mm)**

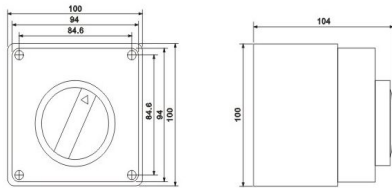

**Plug Bases**



Part No.: AB-PB1  
Single Plug Base



Part No.: AB-PB2  
Double Plug Base

**Features:**

- Volts: 250V
- Amp: 10A
- Pin No: 3 Flat Pin
- Dimensions single: 95mm(Width)66(Diameter)58mm(H)
- Dimensions Double: 95mm(Width)66(Diameter)74mm(H)
- Mounting Centres: 50mm
- Terminals: 4 Terminals which accommodate 4x4mm<sup>2</sup> cables
- Certified with AS/NZS 3112 and AS/NZS 3100
- Approval No.: TUV16374EA

**Batten Holders**



Part No.: AB-BH1  
Batten Holder



Part No.: AB-BH2  
Batten Holder with Plugs

**Features:**

- Rated Voltage: 250V a.c. 50Hz
- 150W Maximum Rating
- Base diameter 70mm with 50 to 53mm mounting centres.
- Terminals: 4 Terminals which accommodate 4X2.5mm<sup>2</sup> cables
- Batten Holder-Bayonet fitting B22
- Certified with AS/NZS 61184
- Approval No.: TUV16394EA

**Description**

- White batten holder-Bayonet fitting(B22)

**Features:**

- Accommodate up to 7 x 2.5mm<sup>2</sup> cables
- Insulator-Blue flame retardant PVC
- Deep Screw Head provides easy tightening
- Combination Phillips/Flat
- 32A 240/415V



Part No.: AB-SC1  
Single Screw Connector 100PK



Part No.: AB-SC2  
Double Screw Connector 50PK



- Flat end screw
- Insulator-Blue flame retardant PC
- Deep Screw Head provides easy tightening  
Combination Phillips/Flat

**Features:**

- Large Junction Box with connectors  
Part No.: AB-LJB  
Dimensions(mm): 100(L)x65(W)x48(H)  
Includes connectors
- Small Junction Box with connectors  
Part No.: AB-SJB  
Dimensions(mm): 81(L)x61(W)x40(H)  
Includes connectors



**Features:**

- High Mounting Block Height 37mm  
Dimensions(mm): 123(L)x75(W)x37(H)  
Part No.: AB-MB36
- Shallow Mounting Block Height 18mm  
Dimensions(mm): 119(L)x75(W)x18(H)  
Part No.: AB-MB18



**Features:**

- Part No.: AB-ISC216  
Accommodate up to 2 x 16mm<sup>2</sup> cables
- Part No.: AB-ISC235  
Accommodate up to 2 x 35mm<sup>2</sup> cables



\*Insulated Screw Connector  
\*Insulator-Light Blue flame retardant PVC  
\*Combination Phillips/Flat