

HM Cable Lug

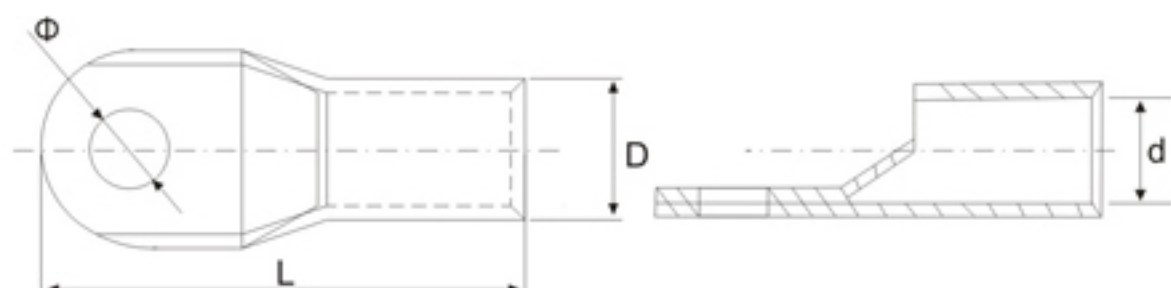

Hm cable lug is made of copper at least 99.8% purity, surface is finished with Tin, it has longer cable tube which is more reliable for connection.

Type	Dimensions(mm)			
	D	d	L	φ
HM 1.5-4	3.1	1.9	18	4.2
HM 1.5-5	3.1	1.9	18	5.2
HM 1.5-6	3.35	1.9	18	6.5
HM 2.5-4	4	2.8	20	4.3
HM 2.5-5	4	2.8	20	5.2
HM 2.5-6	4	2.6	20	6.5
HM 4-4	4.5	3.2	20.5	4.3
HM 4-5	4.5	3.2	20.5	5.2
HM 4-6	4.5	3.2	22	6.5
HM 6-5	5.1	3.7	22	5.2
HM 6-6	5.1	3.7	23	6.5
HM 6-8	5.3	3.7	24	8.4
HM 6-10	5.3	3.7	24	10.3
HM 10-6	6.1	4.5	24	6.5
HM 10-8	6.1	4.5	25	8.4
HM 10-10	6.3	4.5	26.5	10.3
HM 16-6	7.3	5.7	27.5	6.5
HM 16-8	7.3	5.7	29.5	8.4
HM 16-10	7.5	5.7	30	10.5
HM 25-6	9	7.2	32.5	6.5
HM 25-8	9	7.2	33	8.4
HM 25-10	9	7.2	34	10.5
HM 25-12	9	7.2	37	13
HM 35-6	10.8	8.5	36	6.5
HM 35-8	10.8	8.5	37	8.5
HM 35-10	10.8	8.5	38	10.5
HM 35-12	10.8	8.5	38	13
HM 50-6	12.5	9.8	41	6.5
HM 50-8	12.5	9.8	42.5	8.5
HM 50-10	12.5	9.8	44	10.5
HM 50-12	12.5	9.8	44	13
HM 50-14	12.5	9.8	44	14.7
HM 70-8	14.5	11.5	48.5	8.5
HM 70-10	14.5	11.5	50	10.5
HM 70-12	14.5	11.5	50	13
HM 95-8	17	13.7	57	8.5
HM 95-10	17	13.7	57	10.5
HM 95-12	17	13.7	57	13
HM 95-14	17	13.7	57	15

Type	Dimensions(mm)			
	D	d	L	φ
HM 95-16	17	13.7	57	17
HM 120-10	19	15	61.5	10.5
HM 120-12	19	15	63	13
HM 120-14	19	15	63	14.7
HM 120-16	19	15	63.5	17
HM 120-20	19	15	67.5	21
HM 150-10	21	16.7	71	10.5
HM 150-12	21	16.7	71	13
HM 150-14	21	16.7	71	14.7
HM 150-16	21	16.7	71	17
HM 185-10	23.5	19.2	77	10.5
HM 185-12	23.5	19.2	77	13
HM 185-14	23.5	19.2	77.5	14.7
HM 185-16	23.5	19.2	79	17
HM 185-18	23.5	19.2	79	18.7
HM 180-20	23.5	19.2	79	21
HM 240-10	26	21	89.5	10.5
HM 240-12	26	21	89.5	13
HM 240-14	26	21	90	14.7
HM 240-16	26	21	91	17
HM 240-20	26	21	92	21
HM 300-10	30	24	100	10.5
HM 300-12	30	24	100	13
HM 300-16	30	24	100	17
HM 300-20	30	24	102	21
HM 400-12	34	27	111	13
HM 400-16	34	27	111	17
HM 400-18	34	27	113	18.5
HM 400-20	34	27	113	21
HM 500-16	38	30	123	17
HM 500-20	38	30	123	21
HM 630-16	44	35	135	17
HM 630-20	44	35	135	21
HM 630-22	44	35	135	23
HM 800-20	50	39	170	21
HM 800-22	50	39	170	23
HM 1000-20	56	44	200	21
HM 1000-22	56	44	200	23